

# Super Simple Mode

## BORA Professional 2.0

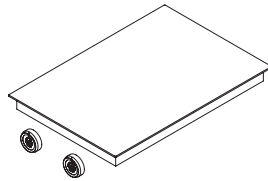

### Super Simple Mode:

<b>Leistungsstufe einstellen</b> ✓	<b>Powerstufe</b> ✓	<b>Brückenfunktion</b> ✓
Adjusting the power level	Power setting	Bridging function
Ajustar el nivel de potencia	Función booster	Función puente
Réglage du niveau de puissance	Niveau Power	Fonction de pont
Impostazione del livello di potenza	Livello Power	Funzione bridge
Vermogensniveau instellen	Powerniveau	Brugfunctie

### Super Simple Mode aktivieren / activate / activar / activer / attivare / activeren

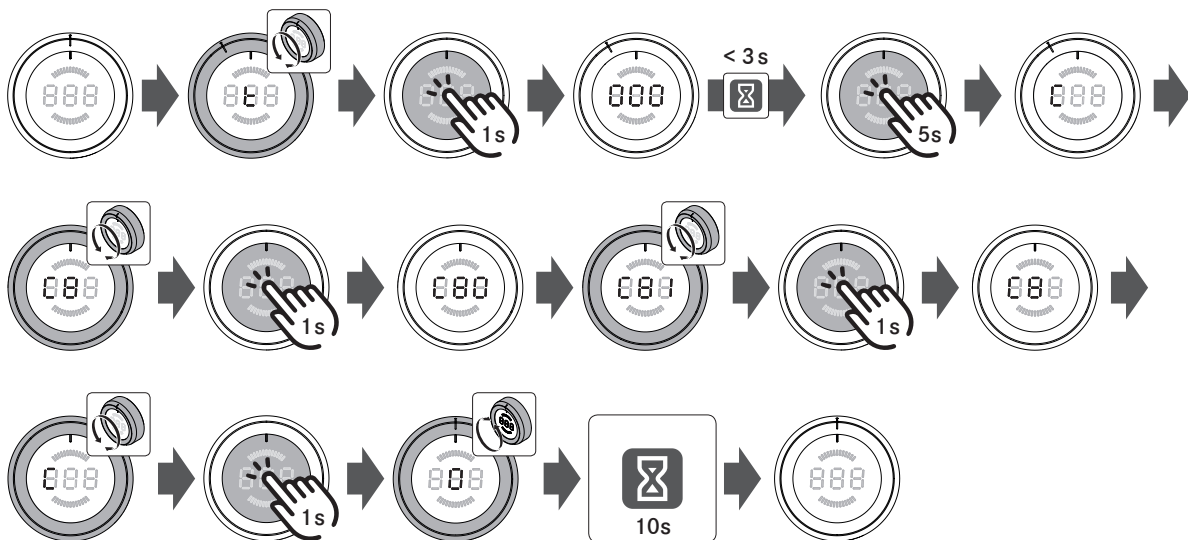

### Super Simple Mode deaktivieren / deactivate / desactivar / désactiver / disattivare / deactiveren

